

REPUBLIC OF THE PHILIPPINES PROVINCE OF LA UNION MUNICIPALITY OF BURGOS	PROJECT TITLE: RESTORATION/REHABILITATION IMPROVEMENT OF FMR AT BILIS-TUMAPOC BOUNDARY (PILIG) LOCATION: UPPER TUMAPOC, BURGOS, LA UNION	PREPARED BY: LEO N. BALCITA DRAFTSMAN	CHECKED BY: FERDINAND G. RAMOS MUNICIPAL ENGINEER	APPROVED BY: DELFIN C. COMEDIS, JR. MUNICIPAL MAYOR	SHEET CONTENT PLAN TYPICAL ROADWAY SECTION	SHEET NO. A-01
--	--	--	--	--	---	--------------------------

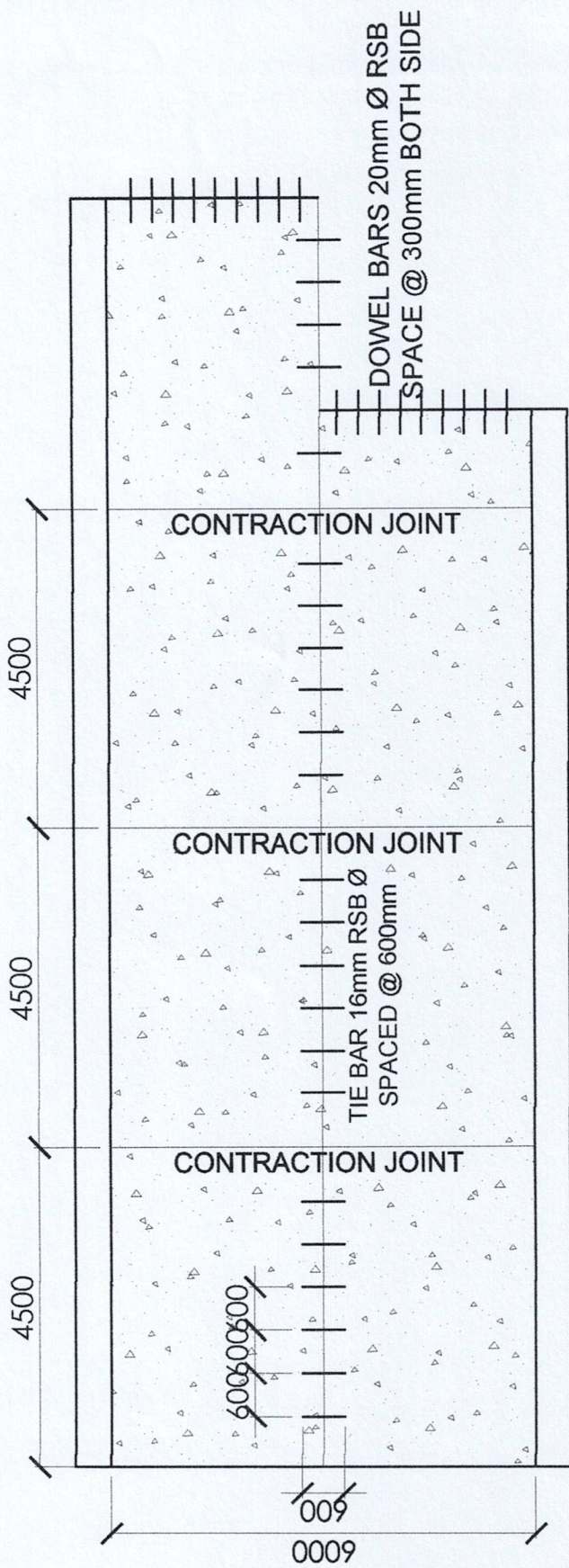

TYPICAL ROADWAY DETAIL
NTS.
SCALE: $\frac{2}{A-2}$

- ITEM 311- PORTLAND CEMENT CONCRETE PAVEMENT 200mm THICKNESS
- ITEM 200- AGGREGATES BASE COURSE 150mm THICKNESS
- ITEM 105- SUBGRADE PREPARATION
- FILLED W/ ASPHALT SEALANT (30-40) PENETRATION BLOWN ASPHALT
- 16mm Ø TIE BAR BY 600mm SPACED @ 600mm O.C

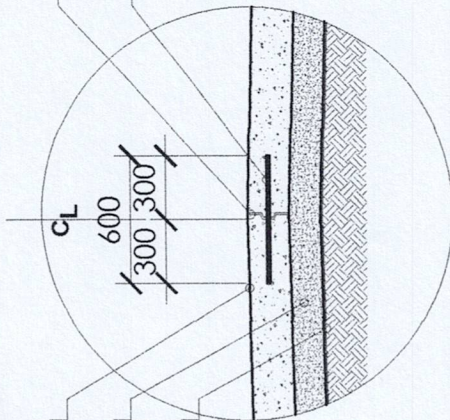

CONSTRUCTION/LONGITUDINAL/ JOINT IN CARRIAGEWAY
NTS.
SCALE: $\frac{2}{A-2}$

REPUBLIC OF THE PHILIPPINES PROVINCE OF LA UNION MUNICIPALITY OF BURGOS	PROJECT TITLE: RESTORATION/REHABILITATION IMPROVEMENT OF FMR AT BILIS-TUMAPOC BOUNDARY (PILIG) LOCATION: UPPER TUMAPOC, BURGOS, LA UNION	PREPARED BY: LEO N. BALCITA DRAFTSMAN	CHECKED BY: FERDINAND S. RAMOS MUNICIPAL ENGINEER	APPROVED BY: DELVIN C. COMEDIS, JR. MUNICIPAL MAYOR	SHEET CONTENT TYPICAL ROADWAY DETAIL CONSTRUCTION/ LONGITUDINAL JOINT IN CARRIAGEWAY	SHEET NO. A-03
--	--	--	--	--	--	--------------------------